

ARCHITECTURE + DESIGN

ARCHITECTURE
AWARDS
RECOGNISE

OUT-OF-THE-BOX CONCEPTS

The Institutional Architecture Award

Special Mention



Rahul Deshpande

Awardee: Rahul Deshpande & Associates, Goa

Project: Revitalisation of Mangueshi Temple Complex, Goa

Despite the numerous facelifts carried out on the Mangueshi temple, nothing concrete took shape to build a visual rapport between the bulky structures, subsidiary to the main temple of Shiva. The architectural interventions did not facilitate such a connection between the *agarshalas* (dormitories) and the temples of Kal Bhairavi and Mulkeshwar. Piling on the list that called for attention was the need to streamline the haphazard flow of tourists and devotees. The passage of time brought newer needs which the existing plan could not cater to.

The configuration of the structures in the temple complex has been executed following the Vedic principles of Vastu Shastra. The reconstructed Tulsi Vrindavan is a classic point to mark the case. The renovation laid emphasis on functionality and has amalgamated modern sensibilities with traditional sentiments. While working on the plan of the renovations, it formed a part of the design principle,



to subdue the smaller structures like the minor temples, *prakar* and *agarshalas* to the magnanimity of the main temple of Shiva. The end result is that none of the structures stand out. They instead converse with each other in a solemn and subtle manner. The refurbishment of the two smaller temples and *agarshalas* was a fine balance act. Care had to be taken so as not to indulge in anything that would go contrary with the character of the temple. But at the same time, the need for modernity lurked from every corner. The final outcome was an approach where, 'the context and expression were modern but the language still vernacular'. +

FactFile

Client: Mangueshi Devasthan | **Design team:** Rahul Deshpande | **Structural design team:** Rahul Deshpande, Anil Palekar, Archana Mahambare, Nisarg Gaude | **Project management consultancy:** Rahul Deshpande, Ranjeesh Gopal | **Contractor:** M/s Omkar Constructions Co and Pankaj Electricals & Engineering Services | **Built-up area:** 2,000sq m | **Area of development:** 5,039sq m | **Cost of project:** Rs 5 crore | **Year of completion:** 2010

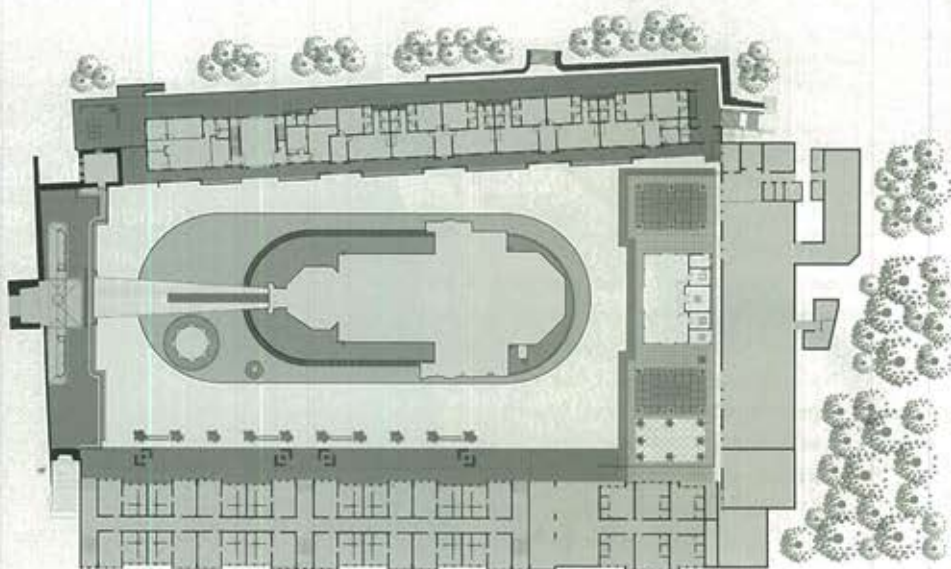

SITE PLAN